

**250 Bulwara Road ULTIMO NSW**

2  1 

This charming two bedroom terrace combines character and city-side convenience in a gorgeous leafy streetscape. The property is an entry level inner-city house in a wonderfully convenient village setting moments to Darling Harbour, CBD and all amenities.

**Type** : House  
**Land Size** : 55 sqm  
**View** : <https://www.gwre.com.au/8065614>

- \* Separate living dining spaces featuring polished timber floors
- \* Two bedrooms, main with a leafy outlook
- \* Upgraded kitchen and bathroom
- \* Sunny paved garden courtyard
- \* Move in now or ready to rent
- \* Stroll to parks, cafes, transport, University precinct, Broadway

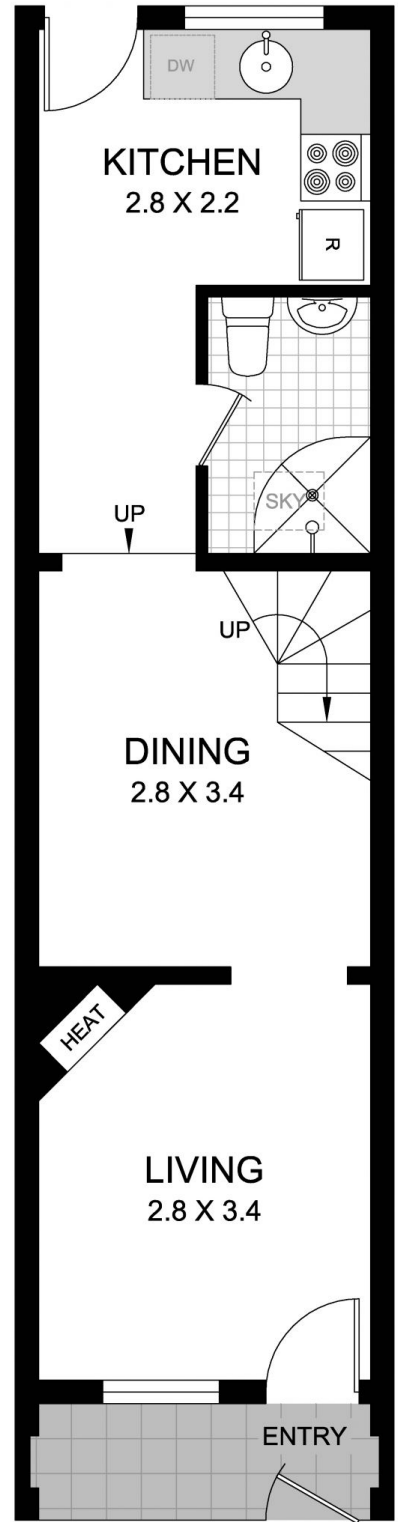
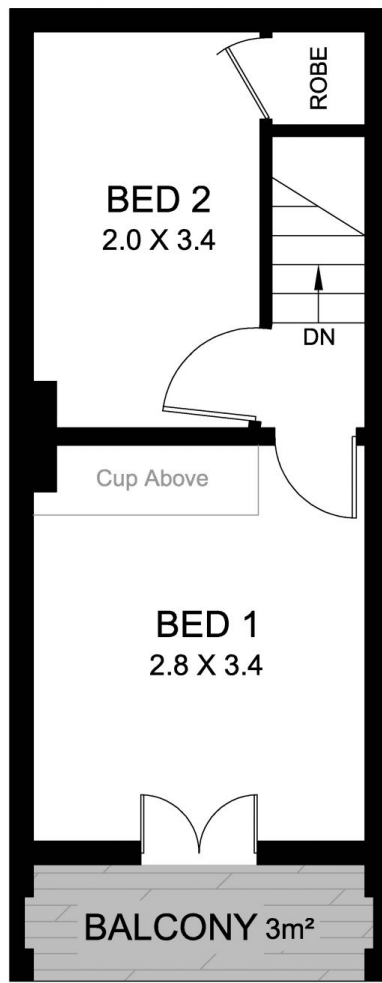

BULWARA ROAD

LEVEL 2

LEVEL 1

**SITE PLAN**

(at reduced scale)

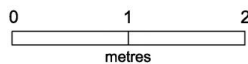

This plan is for illustrative purposes only and dimensions are approximate. It does not constitute part of any legal document or commercial contract for the sale or lease of this property.

250 BULWARA ROAD  
ULTIMO