



### 43A Ferry Road GLEBE NSW

2 1

Perfectly located adjacent to Ernest Pederson Reserve in one of Glebe's blue ribbon locations, this terrace presents a rare opportunity to invent a new style of living. Moments to local cafe's, award winning restaurants, city bus and light rail only 100m walk to the foreshore and harbour front promenade along Blackwattle Bay.

**Type** : House  
**Land Size** : 107 sqm  
**View** : <https://www.gwre.com.au/8065558>

- Currently without kitchen and bathroom
- Two bedrooms with original fireplaces
- Ornate features throughout, timber floors
- Ideal northerly rear aspect

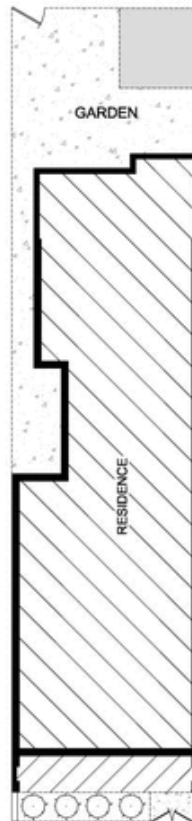
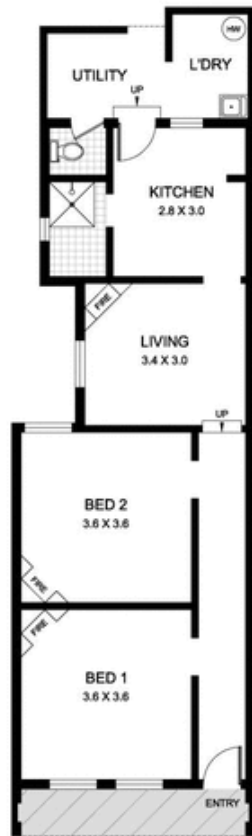

43A FERRY STREET GLEBE

PLUMB DIVISIONS ARE ONLY INDICATIVE OF LAYOUT.  
DIMENSIONS ARE APPROXIMATE

0 1 2  
SCALE BAR in metres

METRO FLOORPLANS  
0418 223 433