



1004/45 Bowman Street PYRMONT NSW

2  2  1 

This beautifully appointed executive apartment is located on the tenth floor of the iconic Distillery apartments, in the heart of the vibrant Jackson's Landing community.

- Stunning views from waterfront to the Blue Mountains
- Light filled living spaces opening to harbour outlook
- 2 generous bedrooms, main with private balcony
- Galley-style kitchen with stone finishes & Euro appliances
- 2 luxuriously appointed bathrooms, ensuite with bath
- Secure under-cover car parking & lock-up storage facility

Type : Apartment
Building Size : 124 sqm
View : <https://www.gwre.com.au/8065485>

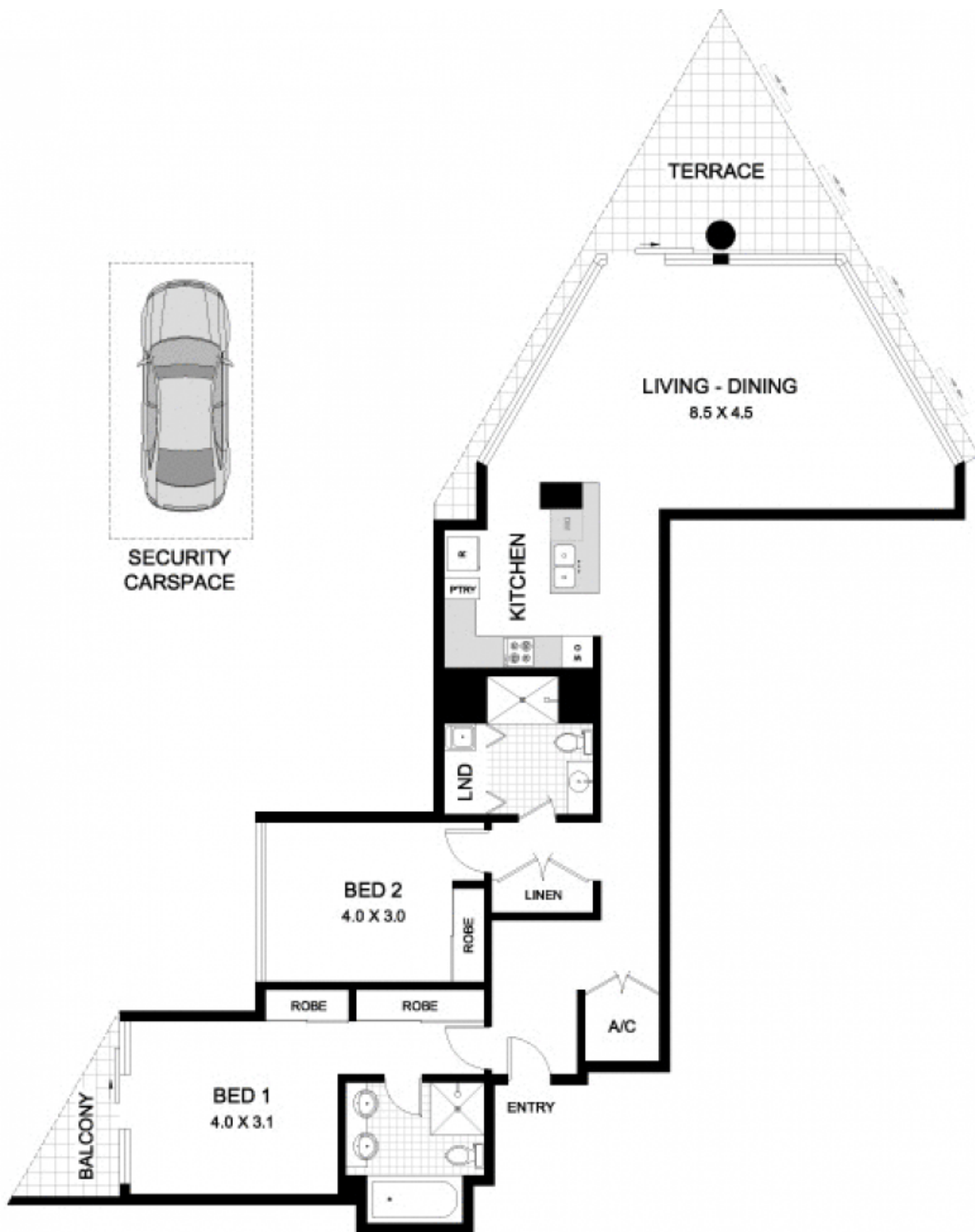

NOTE: 2sqm Storage



1004/45 BOWMAN STREET

PYRMONT

PLANS SHOWN ARE ONLY INDICATIVE OF LAYOUT.
DIMENSIONS ARE APPROXIMATE



METRO FLOORPLANS
0418 223 433



Garry White

FIRST NATIONAL REAL ESTATE