



28 McGrath Avenue FIVE DOCK NSW

4  3  3 

Distinctive and ultra-contemporary, this world class residence displays a superb architectural design dedicated to easy in/outdoor entertaining and occupies a premier bayside position within footsteps to Halliday Park.

Type : House
Land Size : 379 sqm
View : <https://www.gwre.com.au/8065451>

- Light-filled interiors with open living spaces
- Private grassed garden and swimming pool
- Deluxe island kitchen with Miele appliances
- Large upstairs bedrooms with quality carpets
- Main bedroom with spa ensuite, WIR & balcony
- Turpentine hardwood flooring
- Built in speaker system throughout home
- Double garage with internal access
- Ducted air-conditioning, video security system, alarm system

[For full version visit the website](https://www.gwre.com.au)

<https://www.gwre.com.au>

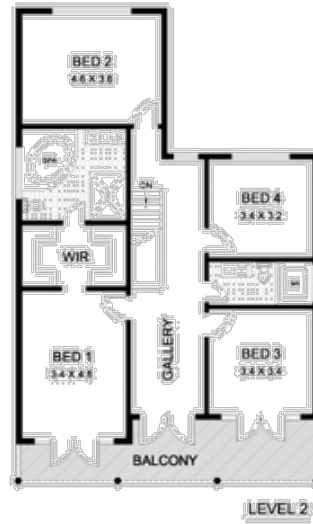
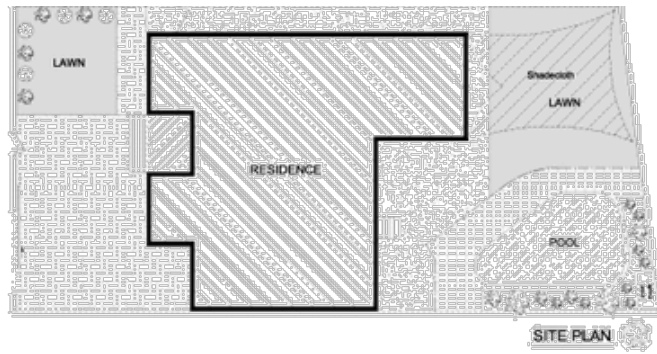

28 McGRATH AVENUE FIVE DOCK

©2010 Architectural Design & Construction Services
 (Professional Seal - Architect)

SCALE BAR IN METERS

METRO FLOORPLANS
 (416) 221-4333