





74/51 Hereford Street GLEBE GLEBE NSW

1  1 

Set in a peaceful position, this studio apartment blends simplistic living with modern convenience, ideally located on the cusp of the ever-changing Cafe culture of Glebe, Sydney University and Broadway shops

Type : Studio
Building Size : 23 sqm
View : <https://www.gwre.com.au/8065391>

- Fully furnished, bright leafy outlook
- Concealed kitchenette and ensuite bathroom
- Resort style pool, sauna and BBQ entertaining facilities
- Astute investment or ideal city pad
- Secure car space, stroll to many transport options
- Currently tenanted lease expiry 19/11/10

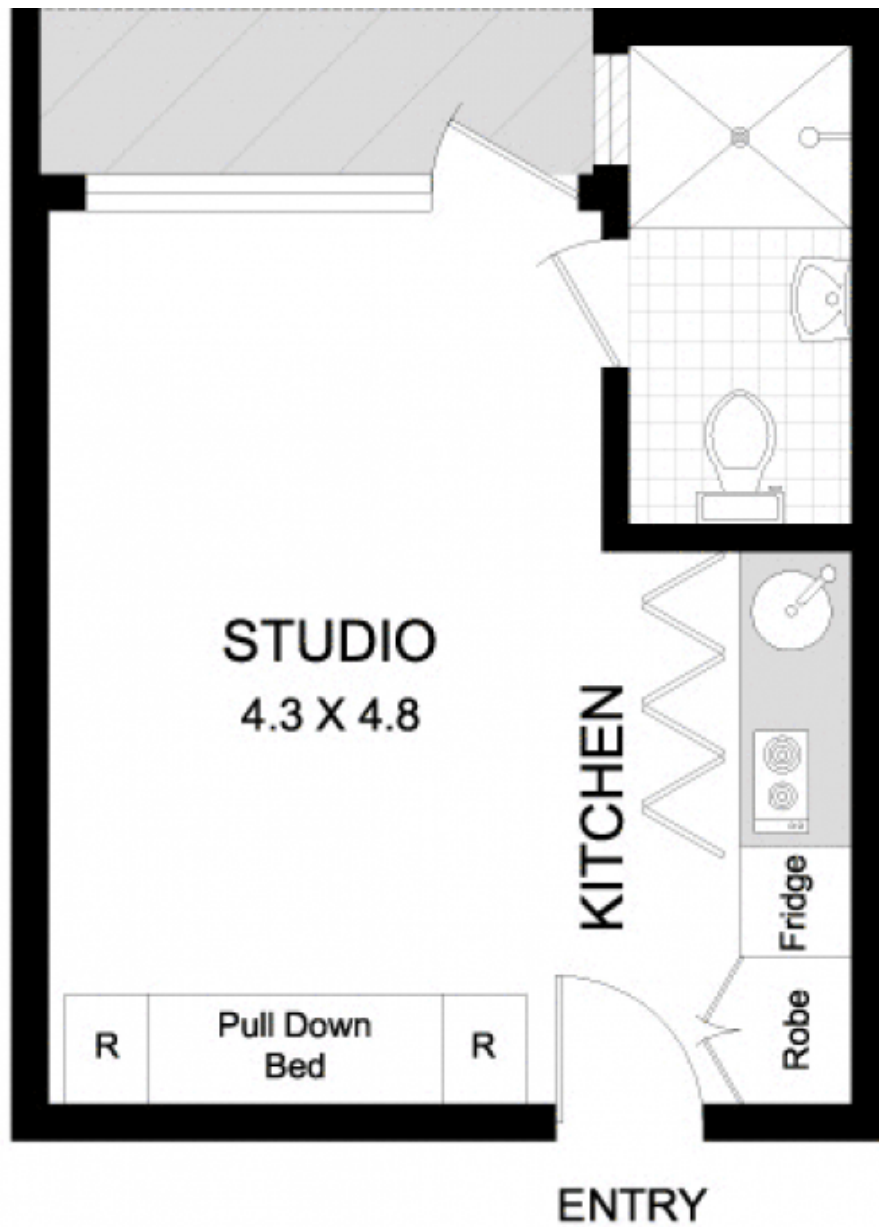

NOTE: SHARED LAUNDRY



74/51 HEREFORD STREET

GLEBE

PLANS SHOWN ARE ONLY INDICATIVE OF LAYOUT. DIMENSIONS ARE APPROXIMATE

0 1 2
SCALE BAR in metres



METRO FLOORPLANS
0418 223 433



Garry White

FIRST NATIONAL REAL ESTATE