

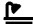

69 Young Street ANNANDALE NSW

3  2  2 

Freestanding to one side, with a rare 261sqm of land, this 2 storey terrace presents a superb opportunity to reinvent a character filled Victorian era home with ample room to extend outwards if desired.

Type : House
Land Size : 261 sqm
View : <https://www.gwre.com.au/8065386>

- Period features including high ornate ceilings
- Spacious separate lounge and dining rooms
- Alfresco dining area and wraparound garden
- Kitchen with gas cooking, internal laundry
- Balcony, study/3rd bedroom, rear lane access
- LUG and car space, vibrant lifestyle location

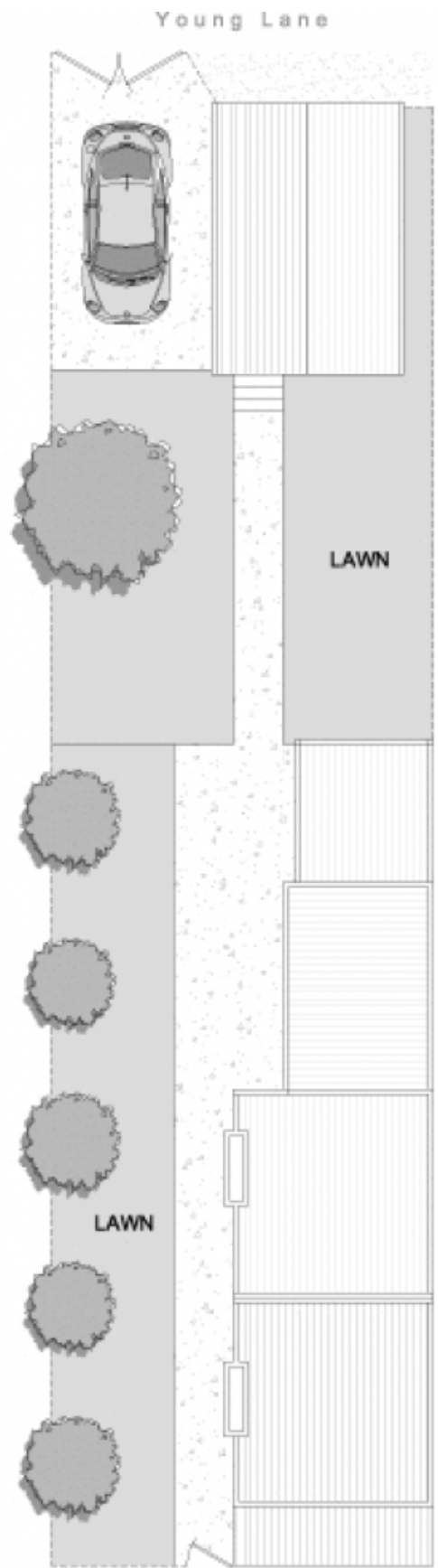
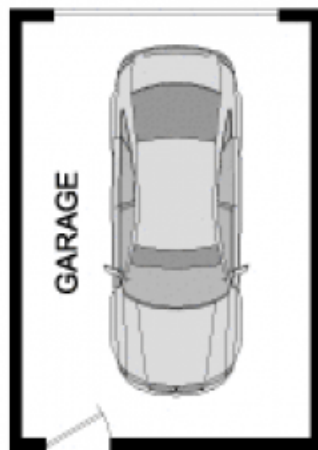
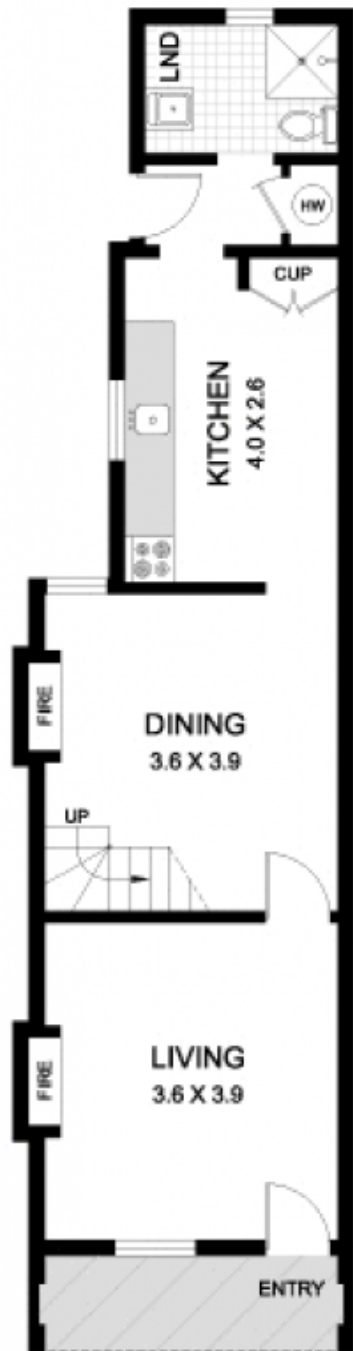

69 YOUNG STREET

ANNANDALE

PLANS SHOWN ARE ONLY INDICATIVE OF LAYOUT.
DIMENSIONS ARE APPROXIMATE



METRO FLOORPLANS
0418 223 433



Garry White

FIRST NATIONAL REAL ESTATE